



Symbol of Secularism
& National Integration

**ANJUMAN-I-ISLAM'S
KALSEKAR TECHNICAL CAMPUS, NEW PANVEL**

School of Architecture

*Approved & Recognised by: All India Council for Technical Education and Council of Architecture, New Delhi
Directorate of Technical Education, Govt. of Maharashtra Affiliated to: University of Mumbai*

SEM-V T.Y.B.ARCH EXAMINATION APRIL 2015 (REVISED COURSE)

Subject: Architectural Building Construction
Max. Marks: 50

Date: 28/04/2015

Duration: 3 Hrs

Notes:

- Question No 1 is compulsory.
- Attempt any two Questions from Q2 to Q4.
- Numbers on the right hand side indicate marks.
- No extra marks for optional questions.

Q1. Design and Detail along with Footing schedule, a Reinforced Concrete Combined foundation for the given Column position. (Figure No 1)

(20)

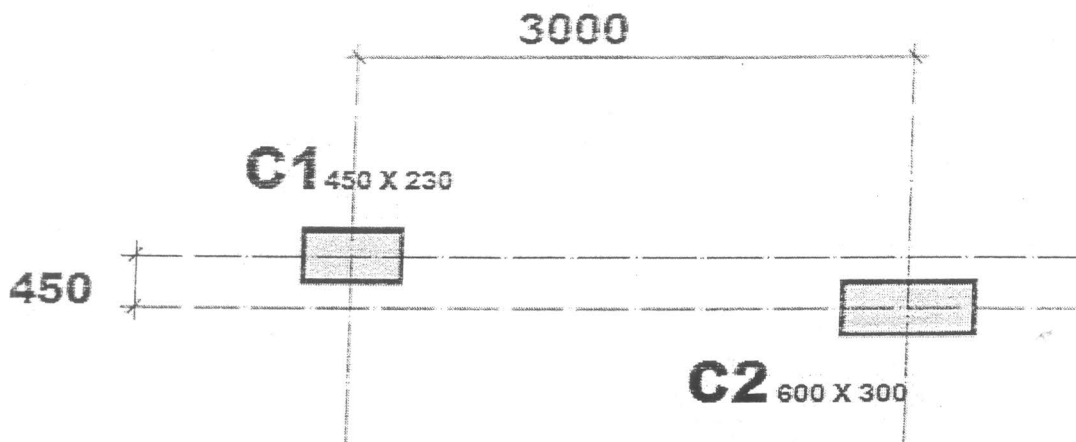

Figure No 1

Q2. Give detailed sketches for the following

(15)

- a. Foundation for a square masonry pier of 2 bricks size
- b. Grillage Foundation for 2 1/2 brick wall
- c. Foundation for 2 brick thk masonry wall
- d. Foundation for RCC Column of 300 mm

Q3. Write short notes on (with detail sketches) (any 3)

(15)

- a) Grillage foundation
- b) Raft foundations
- c) Stepped foundations
- d) Spread foundations

Q4. Differentiate between the following. (with detail sketches) (any 3)

(15)

- a. Grillage Foundation and raft Foundations
- b. Combined footing and Continuous footing
- c. Simple footing and Stepped footing
- d. Shallow Foundations and Deep foundations