



Symbol of Secularism  
& National Integration

ANJUMAN-I-ISLAM'S

KALSEKAR TECHNICAL CAMPUS, NEW PANVEL

School of Architecture

Approved & Recognised by: All India Council for Technical Education and Council of Architecture, New Delhi

Directorate of Technical Education, Govt. of Maharashtra Affiliated to: University of Mumbai

## FOURTH YEAR B.ARCH- SEM VII EXAMINATION NOV 2016

Subject: Architectural Building services

Max Marks: 50

Date: 4/11/2016

Duration: 2 Hrs

Notes:

- All questions are compulsory.
- Numbers on the right hand side indicate marks.
- Draw neat and proportionate sketches wherever required.

Q1. Explain the refrigeration cycle of an Air conditioning system and its components  
with a neat diagram {10}

Q2. a. Which are commonly used air conditioning systems for restaurants? {05}

OR

Q2. b. What are the features of a split air conditioning system?

Q3. How does the condenser water cycle work in a water cooled air conditioning system?  
Explain with the help of a diagram {05}

Q4. a. Explain the functions of an AHU {05}

OR

Q4. b. What do you mean by ventilation? Explain the benefits of a mechanical ventilation system. {05}

Q5.a. What is thermal comfort? Explain the factors affecting the thermal comfort. {05}

OR

Q5.b. Explain the principle and working of Earth Air tunnelling system of Air Conditioning {05}



Q6. Design a mechanical ventilation system for a basement parking lot as shown below.

Requirements: Duct layout showing all the components of a plenum-exhaust system of Ventilation. Layout should be complete with plenum and exhaust location, duct sizes, diffuser locations. (Attach this page with the answer book) {20}

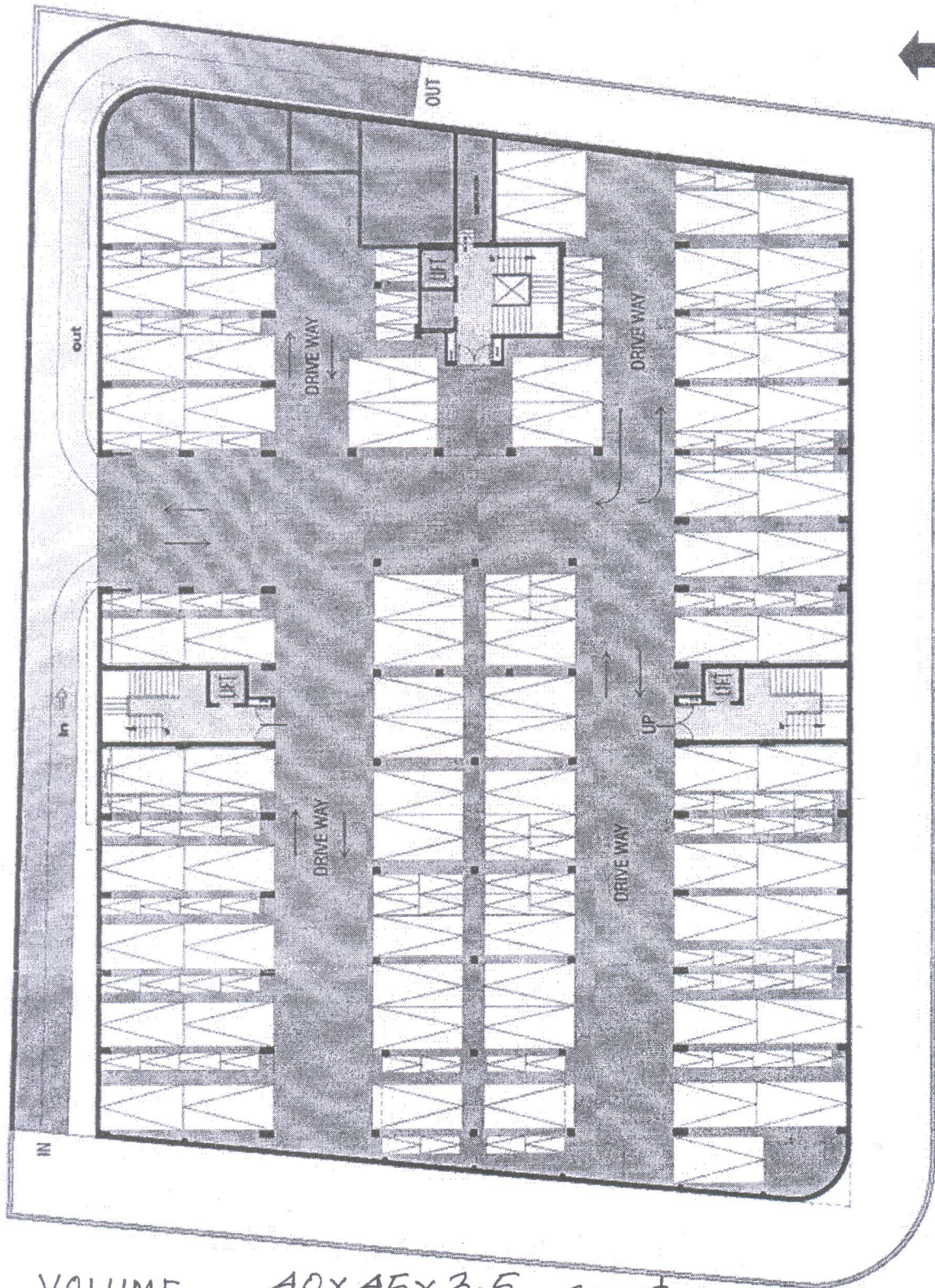

VOLUME —  $40 \times 45 \times 3.5$  cu. mt

NO. OF AIR CHANGE / HR — 15

AIR SPEED — 8 m/s





Symbol of Secularism  
& National Integration

SEM-VII  
PP

ANJUMAN-I-ISLAM'S

KALSEKAR TECHNICAL CAMPUS, NEW PANVEL

*School of Architecture*

*Approved & Recognised by: All India Council for Technical Education and Council of Architecture, New Delhi*

*Directorate of Technical Education, Govt. of Maharashtra Affiliated to: University of Mumbai*

SEMESTER:VII

SUBJECT :PROFESSIONAL PRACTISE

DATE:03/11/2016

ALL QUESTIONS ARE COMPULSARY

[50 MARKS] [3 HOURS]

- Q1] WHAT IS A CONTRACT EXPLAIN TYPES OF CONTRACTS AND DESCRIBE (15 MARKS)  
IN DETAIL any FOUR  
a. SECURITY DEPOSIT  
b. LUM SUM CONTRACT  
c. JOINT VENTURE CONTRACT  
d. TURN-KEY CONTRACT  
e. BOT SYSTEM

OR

- Q1] WHAT DOES AN ARCHITECT SHOULD CONSIDER WHILE SETTING UP HIS OWN OFFICE  
AND ABOUT ITS MANAGEMENT. (15 MARKS)
- Q2] a) WHAT DO YOU MEAN BY THE TERM TENDER (05 MARKS)  
b) WHAT ARE THE REQUIREMENTS TO BE MET WITH BEFORE TENDERS ARE  
INVITED FOR CONSTRUCTION WORK? (05 MARKS)  
c) TYPES OF TENDER (05 MARKS)

OR

- Q2] DESCRIBE IN MIN 10 POINTS PROFESSIONAL ROLE, RESPONSIBILITIES, (15 MARKS)  
DUTIES AND LIABILITIES OF AN ARCHITECT.
- Q3] WRITE SHORT NOTES ON (10 MARKS)  
a) EARNEST MONEY DEPOSIT  
b) LIQUIDATED DAMAGES

- Q4] WHAT ARE INFORMATION TO BE GIVEN IN A TENDER NOTICE EXPLAIN (10 MARKS)

OR

- Q4] DESCRIBE IN BRIEF ARCHITECT' REGISTRATION ACT 1972 (10 MARKS)



SEM-VII  
ABCM

ANJUMAN-I-ISLAM'S

KALSEKAR TECHNICAL CAMPUS, NEW PANVEL

*School of Architecture*

*Approved & Recognised by: All India Council for Technical Education and Council of Architecture, New Delhi*

*Directorate of Technical Education, Govt. of Maharashtra Affiliated to: University of Mumbai*

**FOURTH YEAR B.ARCH- SEM VII EXAMINATION NOVEMBER 2016**

Subject: Architectural Building Construction

Max Marks: 50

Date: 08/11/2016

Duration: 3 Hrs

**NOTES:**

- Question No. 1 and 2 are **compulsory**.
- Attempt **any 2** from Ques. No. 3,4 & 5.
- Draw neat and relevant sketches wherever necessary.

1. What are multilevel basements? Describe the process of the construction of multilevel basements. (15)

OR

Explain pile foundation – its construction process with equipments used . Also explain the various types of piles depending on the soil condition and the material of the pile. (15)

2. Write short notes with sketches (**Attempt Any 4**) (20)

- a. Concrete Boom Placers
- b. Types of Cranes used in High rise construction
- c. Grades of Concrete and Additives
- d. Auto Climbing Formwork
- e. Mivan Formwork
- f. Batching plant and its advantages in construction of highrise.