

[ REVISED COURSE ]

4Hours

Total marks : 80

NOTE:

- i - Question No. 1 is compulsory.
- ii - Attempt any three out of the remaining five questions.
- iii - Figure to the right indicates full marks.
- iv - Assume suitable data if required.

- Q.1 Work out the quantities of following items from given plan & section. (Fig. 01) 20
- a) 12 mm thick Internal plastering in C:M= 1:4
  - b) Brick work (C:M= 1:6) in super structure of ground floor
  - c) Concrete in footings
  - d) F
- Q.2 A). Define rate analysis. Perform rate analysis for Vitrified tile flooring work laid on 25 mm thick base course of cement mortar 1:6 8
- B). What are the points to be observed in framing specification of an item? Explain the legal importance of specification. 8
- C). What are the various sources of rates of items? Prepare the abstract of items of question number 01. 4
- Q.3 A). Prepare an approximate estimate of cost for (G+1) RCC framed Row House, constructed on plot of size 30 feet x 50 feet with FSI=1. Consider cost of construction of super structure = Rs. 800/sqft. Assume other required data. 8
- B). Explain in detail the procedure of submission and opening of tender. 8
- C). Define mass diagram. Explain the use of mass diagram. 4
- Q.4 A). A person purchased a plot measuring 450 sqm at the rate of Rs. 6000 per sqm. Then he constructed a bungalow (on that plot) of built up area 150 sqm, the cost of construction being Rs. 12000 per sqm. Now the owner wishes to let this property ( plot and bungalow together) on monthly rental basis. He expects net return of 6% on land cost and 12% on bungalow cost. Considering the outgoings as 30% of the gross income, suggest suitable monthly rent for this property to owner. 8
- B). What is a contract? What are the different types of civil engineering contract? State the suitability of Item rate contract. How does the contractor quote the rate and get payment in item rate contract? 8
- C). Enlist different methods for valuation of land? Explain Belting method of valuation for land with an example. 4
- Q.5 A). Estimate the quantity of earthwork from chainage 20 to 26 measured with a standard 20 m chain from the data, 8

Chainage	20	21	22	23	24	25	26
Ground Level	88.10	87.74	87.80	88.20	90.75	90.20	89.98
				90.40			

The formation level at chainage. 20 is 88.5 and road has a rising gradient of 1 in 100. The formation width of the road is 10 m and side slope in cutting 1:1 and banking 2:1.



- B). Work out the quantities of reinforcement in footings and columns of question no.0.1 8  
 Steel in footing -F1( 10 $\phi$  @ 150 mm c/c both ways), F2 ( 10 $\phi$  @ 150 mm c/c both ways),  
 Steel in Columns- C1 (main bars 4- 12  $\phi$ , Links 8 $\phi$  @ 200 mm c/c throughout), C2 (main  
 bars 6- 16  $\phi$ , Links 8 $\phi$  @ 200 mm c/c throughout)  
 C). Work out the quantities of different materials in slab (M20) of question no. 01 4

Q.6 4 Write short notes on (any five)

- a.- Lease hold and free hold property
- b.-Time extension clause of contract
- c.-BBS

- d.-Rules for deduction in masonry work as per IS-1200
- e.- Administrative approval
- f.-CBRI equations

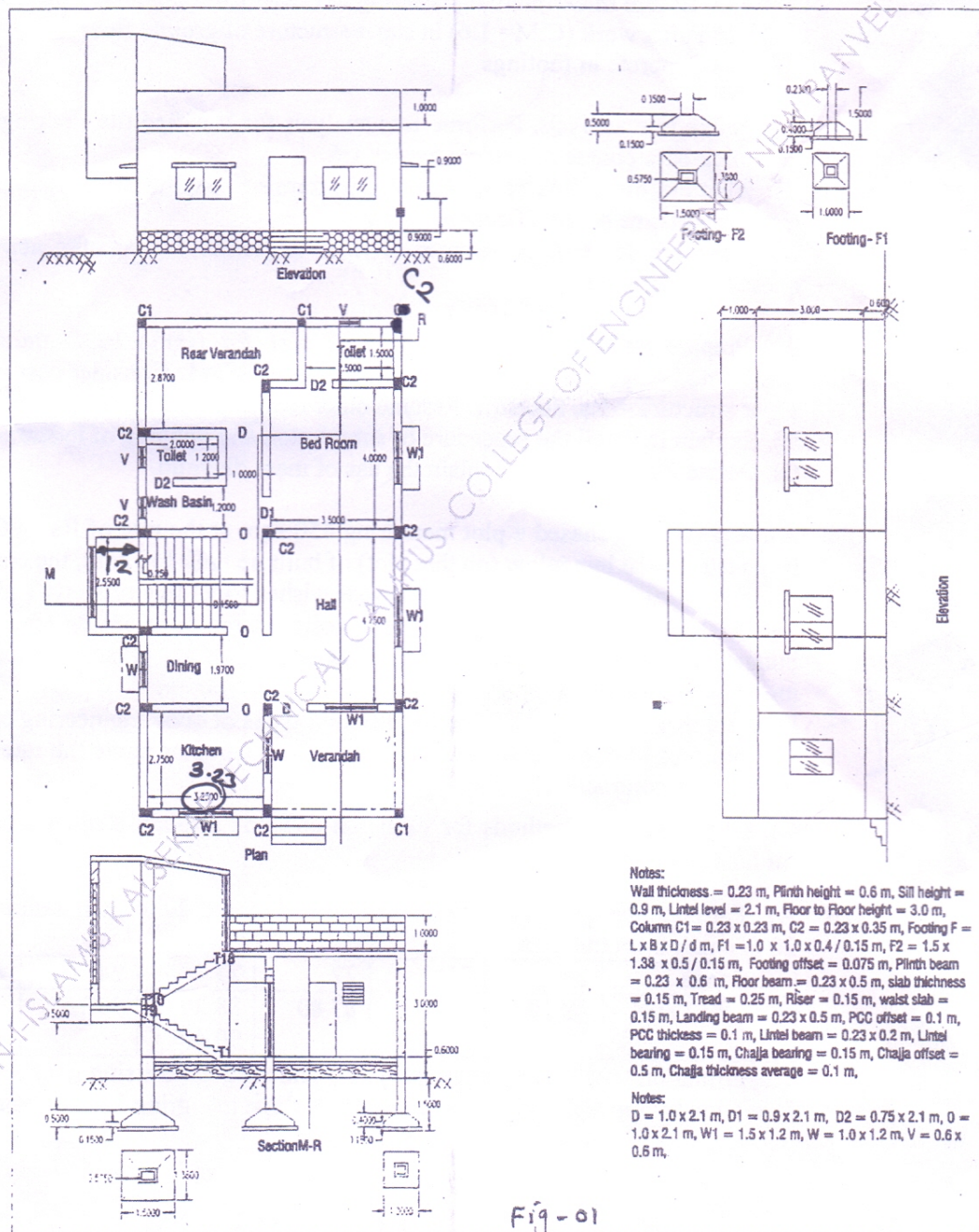



Course: B.E. (Sem VII) (REV. -2012) (CBSGS) (Civil Engg.) (Prog-T2627)

QP Code: 5892

Correction:

Please find herewith correction in (d) of Question number 1

d) Flooring and Skirting

Query Update time: 30/11/2015 11: 52 AM

Students,

Please write your seat NO and sign

S.S,

Pls. write your name & sign

Block 13

1 → 39271492 Mustafa

2 → 39271486 Akady

Prof. Mubashir MBS

J.S →

Block 14

1 → Javed - 39271506

2 → 39271507 Ammar

J.S → Tahoonah Qureshi 30/11/15

Block 15

1 → 32 39271510 Aaraj

2 → 39271511 Hussain

J.S → Randive D.D. Randive

Block 17

1 → 39271542 Abbas

2 → 39271533 Aliza

J.S → Kalpna R. Boda KR



Q.P code 5892

AIKTC → called → university  
exam cell

30-11-2015

gave Prof. Rafique's No  
(DMCOE)

Prof. Rafique gave  
corrections mentioned  
on backside of this  
page.

MRB

Block 13

1) 39271491 - Mah



Prof. M.R. Khan

2) 39271490 - K-faisal

Block 14

1) 39271506 - Jenny



Tahona Gureshi Jr

2) 39271505 - Q

Block 15

1) 39271517 - Dudake



Neha Fakih

Signature

2) 39271516 - Signature

Block 17

1) 39271529 - Signature



Signature - Shradha Hule

2) 39271527 - Signature